

STATE OF SOUTH CAROLINA) FIFTH AMENDMENT TO MASTER DEED
) FOR EGRET'S WALK HORIZONTAL
COUNTY OF CHARLESTON) PROPERTY REGIME

WHEREAS, by its Master Deed dated September 22, 2004, and recorded September 29, 2004 in Book B-511, Page 108 in the Charleston County RMC Office (the "Master Deed"), John Wieland Homes and Neighborhoods of the Carolinas, Inc., a Georgia corporation (the "Developer") created and established on the property described therein, Egret's Walk Horizontal Property Regime ("Regime"). The Master Deed has been amended by instruments recorded in Book N-522, Page 536; Book S-530, Page 506; Book A533, Page 640 and Book _____, Page _____ in the RMC Office for Charleston County, South Carolina. In the Master Deed, the Developer reserved the right to amend the Master Deed to more fully show and delineate the location of previously proposed residential dwelling units as construction is completed.

1. The Master Deed is amended to include Exhibit "A", attached hereto and made a part hereof, which delineates the exact location and dimensions of Units 33 thru 38. Exhibit "A" consists of a plat by Douglas L. DeWolff, SC PLS No. 17565, Southeastern Surveying of Charleston, Inc. dated May 11, 2005 and entitled "A Plat and Plot Plan of Stage 2 Egret's Walk Horizontal Property Regime - Dunes West Units 33 thru 38 Owned by John Wieland Homes and Neighborhoods of the Carolinas, Located in the Town of Mount Pleasant, Charleston County, South Carolina.
2. All other terms and provisions of the Master Deed shall remain in full force and effect.

IN WITNESS WHEREOF, the undersigned have set their hands and seals this 19th day of May, 2005.

Greg DeCar
Paula Langford

DEVELOPER:
John Wieland Homes and Neighborhoods of the Carolinas, Inc., a Georgia Corporation
By: Andrea Lofstrand
Andrea Lofstrand
Assistant Secretary

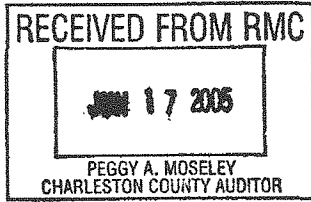

STATE OF GEORGIA)
COUNTY OF Clayton)

The foregoing instrument was acknowledged before me this 19th day of May, 2005, by John Wieland Homes and Neighborhoods of the Carolinas, Inc., a Georgia Corporation, by Andrea Lofstrand, Assistant Secretary.

Jonathan F. Young
Notary Public for
My Commission Expires: JULY 14, 2008
ASSOCIATION:
Egret's Walk Condominium Association, Inc.,
A South Carolina Nonprofit Corporation

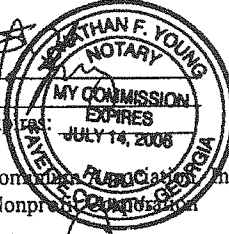

[Signature]
[Signature]

By: Frederick D. Evans, III
Frederick D. Evans, III
Secretary

STATE OF Georgia)
COUNTY OF Clayton)

The foregoing instrument was acknowledged before me this 19th day of May, 2005 by Egret's Walk Condominium Association, Inc., by Frederick D. Evans, III, Secretary.

Jonathan F. Young
Notary Public for
My Commission Expires:

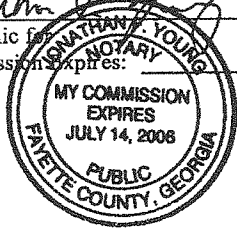

A PLAT AND PLOT PLAN OF STAGE 2
BRETT'S WALK HORIZONTAL PROPERTY REGIME - DUNES WEST

UNITS 33 THRU 38
 OWNED BY JOHN WILKINSON AND NEIGHBORHOODS OF THE CAROLINAS
 CHARLESTON COUNTY, SOUTH CAROLINA

DATE: 5/17/2005
 DRAWN BY: J. SMITH
 CHECKED BY: J. SMITH
 JOB NO.: 03086
 SHEET 1 OF 2

Southeastern Surveying
 147 Rapoon Creek Drive - Suite 102
 Charleston, South Carolina 29412
 843-793-9330 FAX 793-2007 WWW.SS3-SC.COM

NO.	DATE	DESCRIPTION

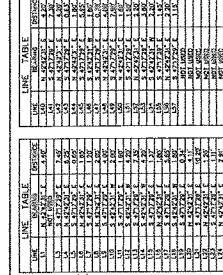

UNIT	AREA	PERCENT	PERCENT	PERCENT
1	1,113.18	5.57	2.27	2.04
2	1,113.18	5.57	2.27	2.04
3	1,113.18	5.57	2.27	2.04
4	1,113.18	5.57	2.27	2.04
5	1,113.18	5.57	2.27	2.04
6	1,113.18	5.57	2.27	2.04
7	1,113.18	5.57	2.27	2.04
8	1,113.18	5.57	2.27	2.04
9	1,113.18	5.57	2.27	2.04
10	1,113.18	5.57	2.27	2.04
11	1,113.18	5.57	2.27	2.04
12	1,113.18	5.57	2.27	2.04
13	1,113.18	5.57	2.27	2.04
14	1,113.18	5.57	2.27	2.04
15	1,113.18	5.57	2.27	2.04
16	1,113.18	5.57	2.27	2.04
17	1,113.18	5.57	2.27	2.04
18	1,113.18	5.57	2.27	2.04
19	1,113.18	5.57	2.27	2.04
20	1,113.18	5.57	2.27	2.04
21	1,113.18	5.57	2.27	2.04
22	1,113.18	5.57	2.27	2.04
23	1,113.18	5.57	2.27	2.04
24	1,113.18	5.57	2.27	2.04
25	1,113.18	5.57	2.27	2.04
26	1,113.18	5.57	2.27	2.04
27	1,113.18	5.57	2.27	2.04
28	1,113.18	5.57	2.27	2.04
29	1,113.18	5.57	2.27	2.04
30	1,113.18	5.57	2.27	2.04
31	1,113.18	5.57	2.27	2.04
32	1,113.18	5.57	2.27	2.04
33	1,113.18	5.57	2.27	2.04
34	1,113.18	5.57	2.27	2.04
35	1,113.18	5.57	2.27	2.04
36	1,113.18	5.57	2.27	2.04
37	1,113.18	5.57	2.27	2.04
38	1,113.18	5.57	2.27	2.04
39	1,113.18	5.57	2.27	2.04
40	1,113.18	5.57	2.27	2.04
41	1,113.18	5.57	2.27	2.04
42	1,113.18	5.57	2.27	2.04
43	1,113.18	5.57	2.27	2.04
44	1,113.18	5.57	2.27	2.04
45	1,113.18	5.57	2.27	2.04
46	1,113.18	5.57	2.27	2.04
47	1,113.18	5.57	2.27	2.04
48	1,113.18	5.57	2.27	2.04
49	1,113.18	5.57	2.27	2.04
50	1,113.18	5.57	2.27	2.04
51	1,113.18	5.57	2.27	2.04
52	1,113.18	5.57	2.27	2.04
53	1,113.18	5.57	2.27	2.04
54	1,113.18	5.57	2.27	2.04
55	1,113.18	5.57	2.27	2.04
56	1,113.18	5.57	2.27	2.04
57	1,113.18	5.57	2.27	2.04
58	1,113.18	5.57	2.27	2.04
59	1,113.18	5.57	2.27	2.04
60	1,113.18	5.57	2.27	2.04
61	1,113.18	5.57	2.27	2.04
62	1,113.18	5.57	2.27	2.04
63	1,113.18	5.57	2.27	2.04
64	1,113.18	5.57	2.27	2.04
65	1,113.18	5.57	2.27	2.04
66	1,113.18	5.57	2.27	2.04
67	1,113.18	5.57	2.27	2.04
68	1,113.18	5.57	2.27	2.04
69	1,113.18	5.57	2.27	2.04
70	1,113.18	5.57	2.27	2.04
71	1,113.18	5.57	2.27	2.04
72	1,113.18	5.57	2.27	2.04
73	1,113.18	5.57	2.27	2.04
74	1,113.18	5.57	2.27	2.04
75	1,113.18	5.57	2.27	2.04
76	1,113.18	5.57	2.27	2.04
77	1,113.18	5.57	2.27	2.04
78	1,113.18	5.57	2.27	2.04
79	1,113.18	5.57	2.27	2.04
80	1,113.18	5.57	2.27	2.04
81	1,113.18	5.57	2.27	2.04
82	1,113.18	5.57	2.27	2.04
83	1,113.18	5.57	2.27	2.04
84	1,113.18	5.57	2.27	2.04
85	1,113.18	5.57	2.27	2.04
86	1,113.18	5.57	2.27	2.04
87	1,113.18	5.57	2.27	2.04
88	1,113.18	5.57	2.27	2.04
89	1,113.18	5.57	2.27	2.04
90	1,113.18	5.57	2.27	2.04
91	1,113.18	5.57	2.27	2.04
92	1,113.18	5.57	2.27	2.04
93	1,113.18	5.57	2.27	2.04
94	1,113.18	5.57	2.27	2.04
95	1,113.18	5.57	2.27	2.04
96	1,113.18	5.57	2.27	2.04
97	1,113.18	5.57	2.27	2.04
98	1,113.18	5.57	2.27	2.04
99	1,113.18	5.57	2.27	2.04
100	1,113.18	5.57	2.27	2.04

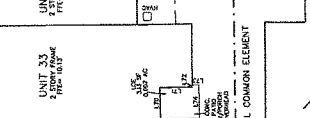

UNIT	AREA	PERCENT	PERCENT	PERCENT
33	1,113.18	5.57	2.27	2.04
34	1,113.18	5.57	2.27	2.04
35	1,113.18	5.57	2.27	2.04
36	1,113.18	5.57	2.27	2.04
37	1,113.18	5.57	2.27	2.04
38	1,113.18	5.57	2.27	2.04

- NOTES:**
1. ANYTHING SHOWN OUTSIDE THE BOUNDARY OF THIS PLAT IS NOT PART OF THIS PLAT AND IS NOT TO BE CONSIDERED.
 2. ALL LOTS SHOWN ON THIS PLAT ARE PRIVATE.
 3. ALL STREETS SHOWN ON THIS PLAT ARE PRIVATE.
 4. ALL LOTS SHOWN ON THIS PLAT ARE PRIVATE.
 5. ALL LOTS SHOWN ON THIS PLAT ARE PRIVATE.
 6. ALL LOTS SHOWN ON THIS PLAT ARE PRIVATE.
 7. ALL LOTS SHOWN ON THIS PLAT ARE PRIVATE.

LEGEND:
 - - - - - FROM PFC OLD
 - - - - - LIMITED COMMON ELEMENT
 - - - - - P17 STREET ADDRESS

REFERENCES:
 - - - - - FROM THE RECORDS OF THE CHARLESTON COUNTY, SOUTH CAROLINA ARCHIVES
 - - - - - THE 99-16-00-206

MULTI-FAMILY ZONING
 (FOR UNITS NOT PLANNED DEVELOPMENT)
 FROM SETBACK: 30 FEET
 FROM STREETS: 30 FEET
 FROM DRIVE (BETWEEN SEPARATE ROWS): 30 FEET
 FROM DRIVE: 30 FEET
 MAXIMUM LOT WIDTH: 100 FEET
 MAXIMUM BUILDING HEIGHT: 40 FEET
 LOT COVERAGE: 40%

GRAPHIC SCALE
 1 inch = 50 feet



CONFIRMATION
 I, THE UNDERSIGNED SURVEYOR, HEREBY CERTIFY THAT THE PLAT AND PLOT PLAN AND ALL THE ELEMENTS THEREON ARE ACCURATELY REFLECTED HEREON.

DOUGLAS L. SMOOT S.C.P.L.S. NO. 17845

17845 S.C.P.L.S. NO. 17845

RECORDS
 11-08 AM 531

Copyright © Southeastern Surveying of Charleston, Inc.

BK 0 538PG019

RECORDER'S PAGE

This page must remain with
the Original Document



Recording
Fee 10.00

State
Fee

County
Fee

Postage

Total 10.00 B

RETURN TO:
Krawcheck & Davidson
9 State Street
Charleston, SC 29401

*from
Kraw
Lybrand*

FILED

0538-016
2005 MAY 27 AM 10:22

CHARLIE LYBRAND
REGISTER
CHARLESTON COUNTY SC

PID VERIFIED
BY ASSESSOR
REP TJR
DATE 6/16/05

RECEIVED FROM RMC
JUN 17 2005
PEGGY A. MOSELEY
CHARLESTON COUNTY AUDITOR